

FLOOR PLANS CAPACITY CHARTS

THE WESTIN

SAN DIEGO
GASLAMP QUARTER



MEETING SPACE OVERVIEW

910 Broadway Circle
San Diego, California 92101
T 619.239.2200 F 619.239.0509
E westingaslampquarter@starwoodhotels.com
westingaslamp.com

THE WESTIN
SAN DIEGO
GASLAMP QUARTER

FOURTH FLOOR

1. SAN DIEGO BALLROOM
2. GARDEN TERRACE
3. SAN DIEGO BALLROOM FOYER

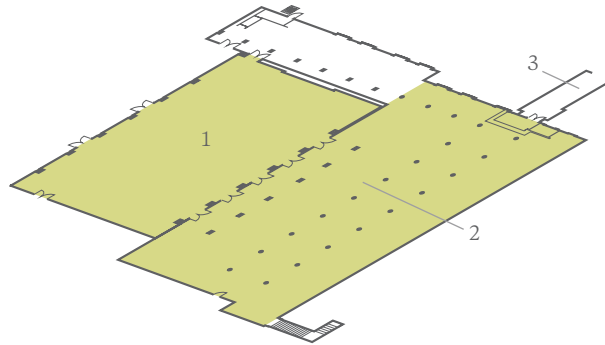

THIRD FLOOR

1. HARBOR
2. HARBOR TERRACE
3. BALBOA
4. CORONADO
5. HARBOR FOYER
6. CORONADO LOUNGE
7. POOL AREA

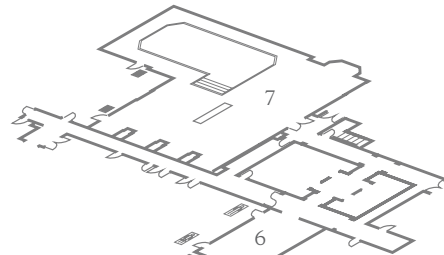

SECOND FLOOR

1. CALIFORNIA BALLROOM
2. CALIFORNIA FOYER
3. PACIFICA BOARDROOM
4. SANTA FE FOYER
5. SANTA FE
6. SIERRA
7. PLAZA
8. PLAZA FOYER
9. IMPERIAL

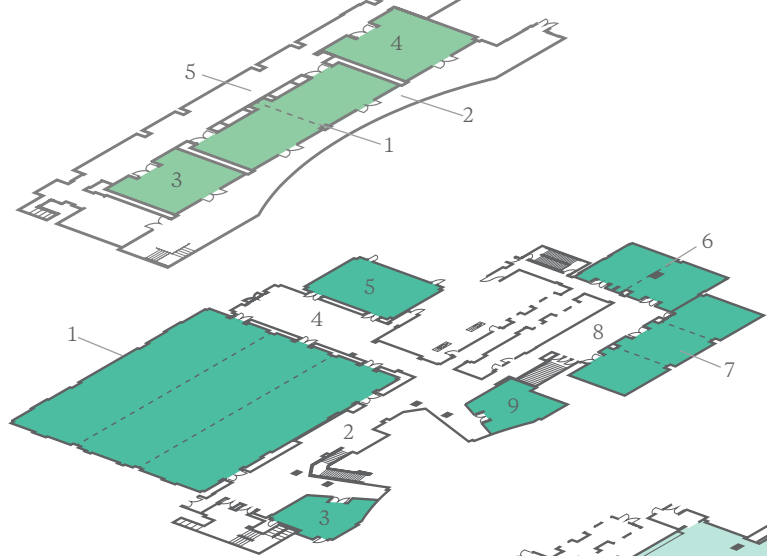

LOBBY LEVEL

1. DEL MAR
2. LA JOLLA
3. SOLANA
4. PINZIMINI RESTAURANT & BAR

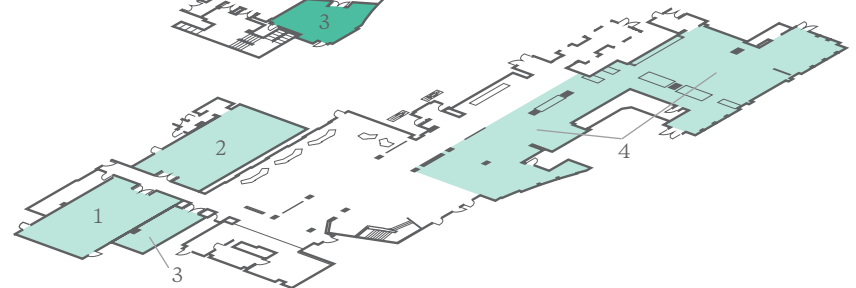

ROOMS AT A GLANCE

TOTAL GUEST ROOMS	450
TOTAL MEETING ROOMS	21
LARGEST MEETING ROOM CAPACITY	1,200
LARGEST MEETING ROOM SIZE	842 m ² / 9,064 ft ²

Additional spaces for meetings and events, not displayed here, may also be available. Contact your hotel representative for more information.

MEETING SPACE FOURTH FLOOR

910 Broadway Circle
San Diego, California 92101
T 619.239.2200 F 619.239.0509
E westingaslampquarter@starwoodhotels.com
westingaslamp.com

THE WESTIN
SAN DIEGO
GASLAMP QUARTER

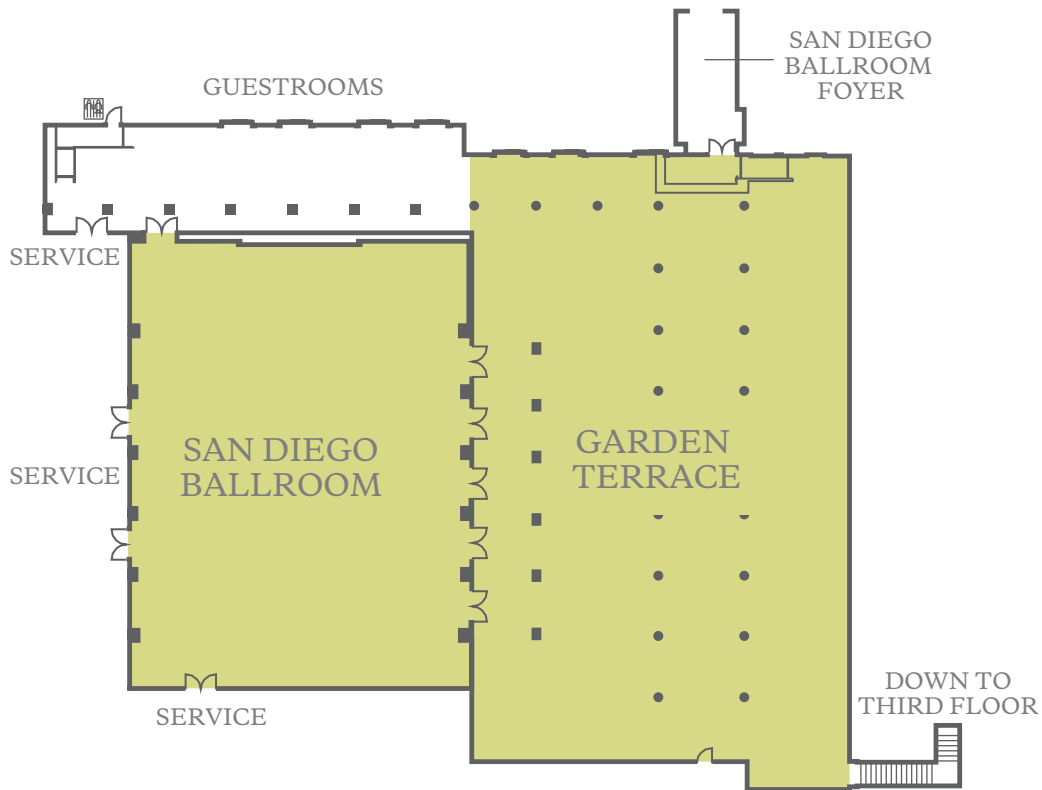

	DIMENSIONS	AREA (SQ. FT.)	MAX CEILING HEIGHT	THEATER	CLASSROOM	BANQUET	CONFERENCE	U-SHAPE	HOLLOW SQ.	RECEPTION
■ GARDEN TERRACE	54' X 107'	5,752	9.5'	—	—	350	—	—	—	400
■ SAN DIEGO BALLROOM	66' X 90'	5,940	18'	650	300	430	—	164	—	600
SAN DIEGO BALLROOM FOYER	28' X 14'	330	10.5'	—	—	—	—	—	—	—

This document contains approximate measurements and square footage that are for illustrative purposes only. We cannot guarantee the floor plan accuracy or completeness, therefore encourage you to review the space to make sure it is suitable for your event.

MEETING SPACE THIRD FLOOR

910 Broadway Circle
San Diego, California 92101
T 619.239.2200 F 619.239.0509
E westingaslampquarter@starwoodhotels.com
westingaslamp.com

THE WESTIN

SAN DIEGO
GASLAMP QUARTER

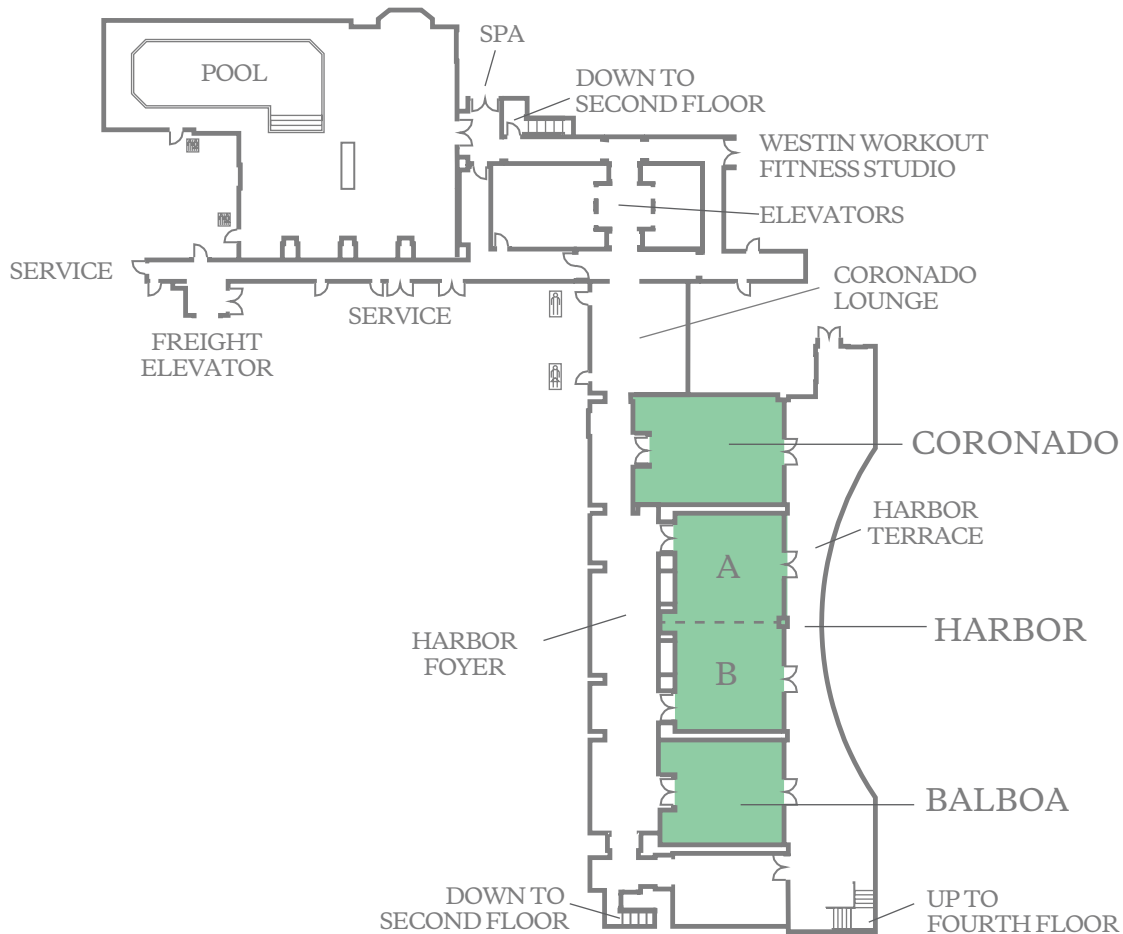

	DIMENSIONS	AREA (SQ. FT.)	MAX CEILING HEIGHT	THEATER	CLASSROOM	BANQUET	CONFERENCE	U-SHAPE	HOLLOW SQ.	RECEPTION
■ BALBOA	25' X 24.5'	716	8'	60	30	48	20	22	26	70
■ CORONADO	25' X 34'	842	8'	80	40	50	28	30	36	85
CORONADO LOUNGE	26' X 22'	400	10'	—	—	—	—	—	—	—
■ HARBOR	25' X 48'	1,200	8'	120	60	80	48	40	46	125
HARBOR FOYER	16' X 50'	800	10'	—	—	—	—	—	—	—
HARBOR TERRACE	28' X 17'	476	—	—	—	80	—	—	—	150
■ HARBOR A	24' X 24'	600	8'	60	30	40	20	22	22	60
■ HARBOR B	24' X 24'	600	8'	60	30	40	20	22	22	60
POOL AREA	83' X 19'	2,806	19'	—	—	—	—	—	—	60

This document contains approximate measurements and square footage that are for illustrative purposes only. We cannot guarantee the floor plan accuracy or completeness, therefore encourage you to review the space to make sure it is suitable for your event.

MEETING SPACE SECOND FLOOR

910 Broadway Circle
San Diego, California 92101
T 619.239.2200 F 619.239.0509
E westingaslampquarter@starwoodhotels.com
westingaslamp.com

THE WESTIN

SAN DIEGO
GASLAMP QUARTER

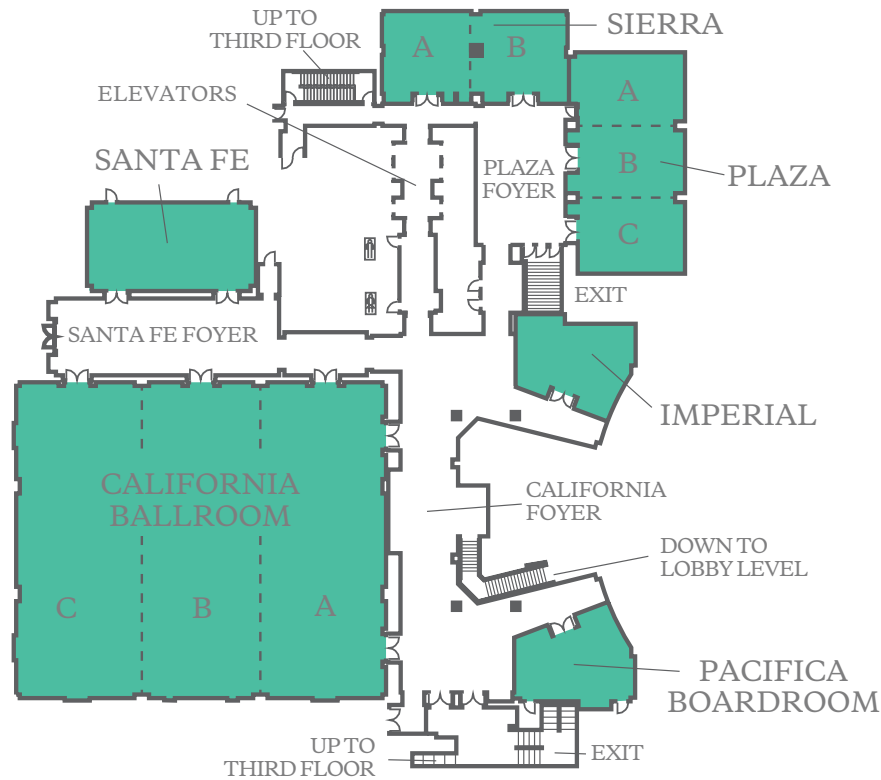

	DIMENSIONS	AREA (SQ. FT.)	MAX CEILING HEIGHT	THEATER	CLASSROOM	BANQUET	CONFERENCE	U-SHAPE	HOLLOW SQ.	RECEPTION
■ CALIFORNIA BALLROOM ABC	87' X 102'	9,064	16'	900	480	690	—	246	—	1,200
■ CALIFORNIA BALLROOM A	35' X 88'	3,080	16'	300	168	230	84	82	88	315
■ CALIFORNIA BALLROOM A - B	68' X 88'	5,984	16'	600	336	460	—	—	—	630
■ CALIFORNIA BALLROOM B	33' X 88'	2,904	16'	300	168	230	84	82	88	315
■ CALIFORNIA BALLROOM B - C	66' X 88'	5,984	16'	600	336	460	—	—	—	630
■ CALIFORNIA BALLROOM C	33' X 88'	3,080	16'	300	168	230	84	82	88	315
CALIFORNIA BALLROOM FOYER	—	—	12'	—	—	—	—	—	—	—
■ IMPERIAL	21' X 30'	700	10'	60	28	40	20	20	22	70
■ PACIFICA	21' X 30'	700	10'	—	—	—	20	—	—	—
■ PLAZA	29' X 60'	1,740	10'	200	100	130	58	52	58	200
PLAZA FOYER	23' X 39'	897	12'	—	—	—	—	—	—	—
■ PLAZA A	29' X 20'	580	10'	66	32	50	20	24	30	60
■ PLAZA A - B	58' X 40'	1,160	10'	132	66	90	38	40	46	120
■ PLAZA B	29' X 20'	580	10'	66	32	40	20	24	30	60
■ PLAZA B - C	58' X 40'	1,160	10'	132	66	80	38	40	46	120
■ PLAZA C	29' X 20'	580	10'	66	32	40	20	24	30	60
■ SANTA FE	24' X 47'	1,128	10'	144	72	80	40	46	50	115
■ SIERRA	50' X 23'	1,150	10'	110	48	80	—	—	—	120
■ SIERRA A	25' X 23'	575	10'	60	27	40	20	18	24	60
■ SIERRA B	25' X 23'	575	10'	60	27	40	20	18	24	60

This document contains approximate measurements and square footage that are for illustrative purposes only. We cannot guarantee the floor plan accuracy or completeness, therefore encourage you to review the space to make sure it is suitable for your event.

MEETING SPACE LOBBY LEVEL

910 Broadway Circle
San Diego, California 92101
T 619.239.2200 F 619.239.0509
E westingaslampquarter@starwoodhotels.com
westingaslamp.com

THE WESTIN
SAN DIEGO
GASLAMP QUARTER

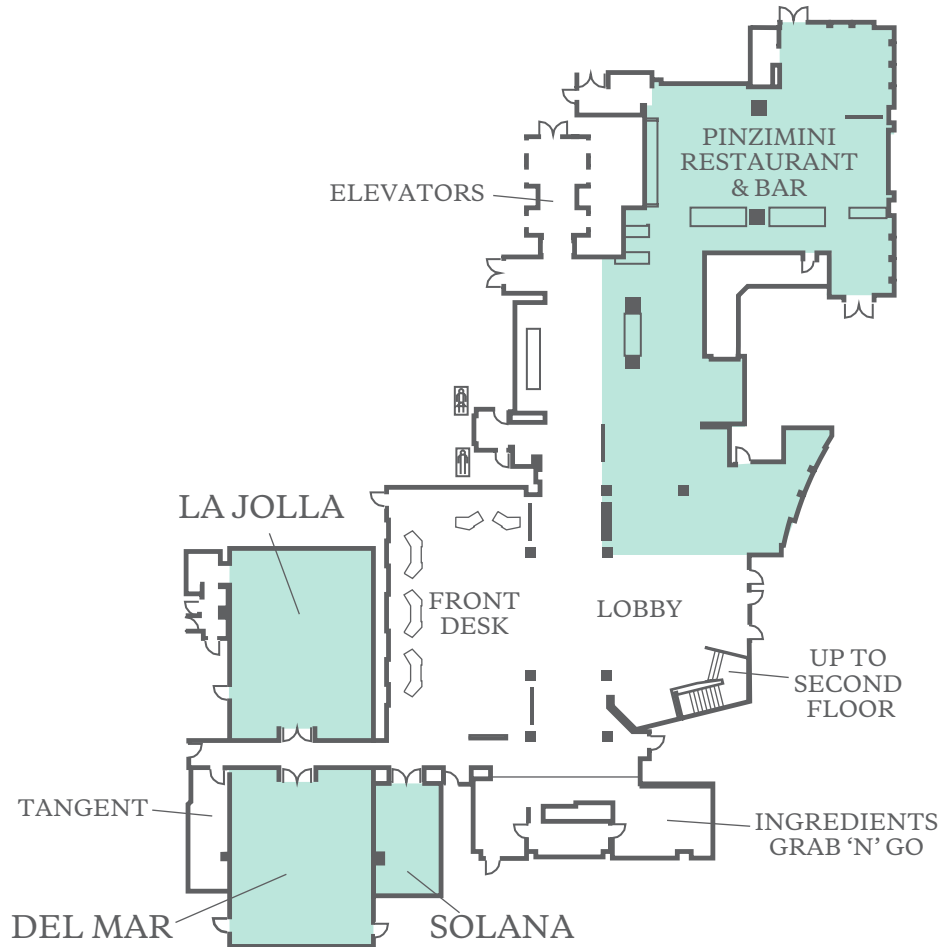

	DIMENSIONS	AREA (SQ. FT.)	MAX CEILING HEIGHT	THEATER	CLASSROOM	BANQUET	CONFERENCE	U-SHAPE	HOLLOW SQ.	RECEPTION
■ DEL MAR	37' X 31'	1,124	10.5'	112	72	80	26	31	34	115
■ LA JOLLA	40.5' X 31'	1,216	11'	112	72	80	28	35	42	120
■ SOLANA	24' X 14'	345	11'	30	16	20	14	12	—	30

This document contains approximate measurements and square footage that are for illustrative purposes only. We cannot guarantee the floor plan accuracy or completeness, therefore encourage you to review the space to make sure it is suitable for your event.



910 Broadway Circle
San Diego, California 92101
T 619.239.2200 F 619.239.0509
E westingaslampquarter@starwoodhotels.com
westingaslamp.com

THE WESTIN
SAN DIEGO
GASLAMP QUARTER